

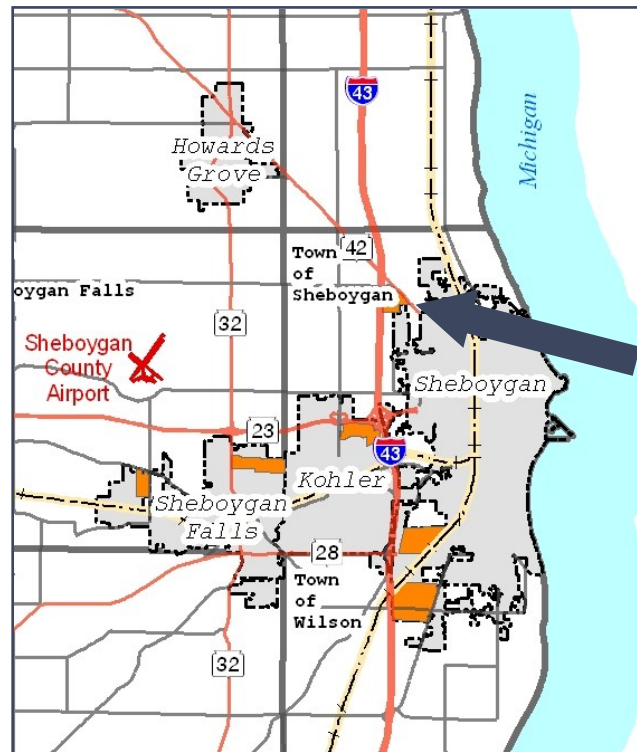

Town of Sheboygan Business Park, Sheboygan, WI **BUSINESS PARK PROFILE**

The Town of Sheboygan Business Park is approximately 110 acres and all parcels are privately owned. This park is conveniently located adjacent to Interstate 43 and along Highway 42. This Park is home to Muth Industries, Scotty's Landscaping, Windridge Homes, and many others. This location is ideal, as can be seen by the small amount of available land.



THE PARK

Available Acres..... 110
Total Acres..... 8
Ownership..... Private
Zoning..... Industrial/Commercial

TRANSPORTATION

Nearest Interstate..... I-43
Distance..... 1 Mile

Nearest Airport..... SBM
Distance..... 7 Miles

Rail Serviced..... NONE
Distance..... NA

UTILITIES

Water..... Municipal
Sewer..... Municipal
Electricity..... Alliant Energy
Natural Gas..... Wisconsin Public Service
Telecom..... AT&T

PROVIDERS

SHEBOYGAN COUNTY

Sheboygan County, Wisconsin is located between Green Bay and Milwaukee, with a direct connection to Chicago. This region is home to many world-renowned corporations, and if you ask them why their headquarters and facilities are located in Sheboygan County, Wisconsin they will tell you this a great place to do business and employees work ethic stands heads and shoulders above the rest.

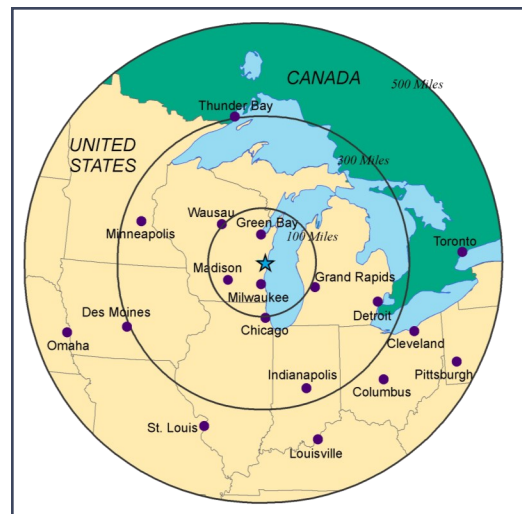

Town of Sheboygan Business Park, Sheboygan, WI BUSINESS PARK PROFILE

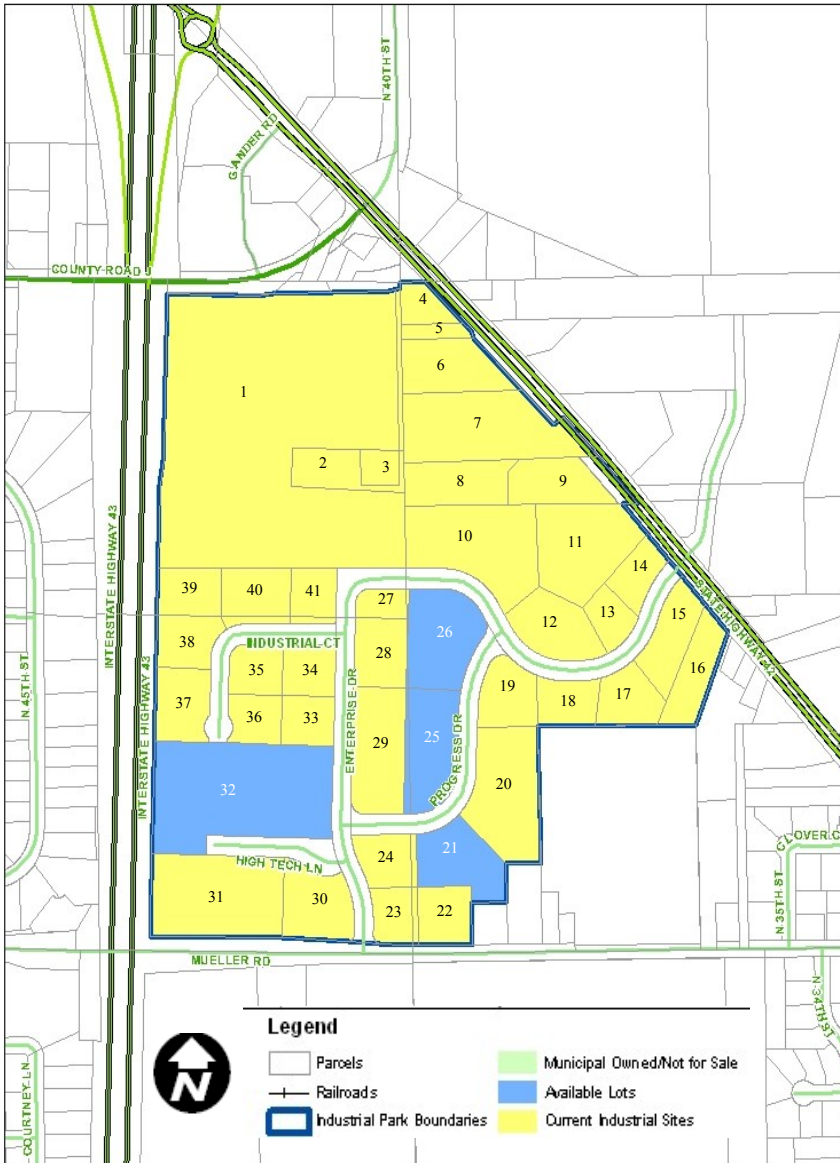

PROPERTY OWNERS

1. Former Menard's Inc.
2. Private Residence
3. Private Residence
4. Shuffs Last Resort
5. Shuffs Last Resort
6. Kohler Credit Union & Habitat for Humanity Restore
7. Harry's Diner, BP Gas Station, First Realty Services, Konz Construction
8. Champion Storage & Rental LLC
9. Kelly Tires/Pomp's
10. Town of Sheboygan Municipal Garage
11. Private Residence
12. Butzen-Durben Welding
13. Private Property
14. Pure Wash
15. Multi-Tenant Building
16. RPM Speed & Custom
17. Fastenel & The Energy Shop
18. Grand Rental Station
19. Scotty's Landscape Supply
20. Scotty's Landscape Supply
21. Available (2.02 acres)
22. B & N Drywall & Paining
23. Industrial Fluid Solutions
24. JJ Trucking
25. Available – Build to Suit (2.56 acres)
26. Available – Build to Suit (2.39 acres)
27. AT&T
28. Novac Resin
29. Motion Industries Inc.
30. Muth Company, LLC
31. Muth Company, LLC
32. Viking Electric – 30,000 Sq. ft. Building (12,500 sq ft available)
33. Conceptworks Inc. Warehouse
34. Packaging Systems of Wisconsin
35. Milwaukee Journal Sentinel
36. Windridge Homes Inc.
37. Birchwood Industrial LLC
38. Greenscape Lawn-Landscape LLC
39. Greenscape Lawn-Landscape LLC
40. Greenscape Lawn-Landscape LLC
41. Car Business Solutions

TOWN OF SHEBOYGAN

The Town of Sheboygan is located in eastern Sheboygan County, along the Lake Michigan shoreline and surrounding the north and west sides of the City of Sheboygan. The Town is a blend of open/green space, single-family residences and unique emerging businesses. The Town offers high quality services with relatively low taxes. The Town considers its open-spaces, natural resources, businesses, and managed/responsible growth to be great assets.

TOWN CONTACT INFORMATION

1512 North 40th Street
Sheboygan, WI 53081
(920) 451-2320
www.townofsheboygan.org