



## Vision Business Park, Sheboygan Falls, WI BUSINESS PARK PROFILE

Vision Business Park, in the City of Sheboygan Falls, currently has 70 City-owned acres available for development. The park is located less than one mile from State Highway 23, on County Highways C and TT. Be one of the first to locate your business in this expanding area. Business park covenants are in place. Rail service will soon be reinstated to the area. There are possible options for expansion to Vision Business Park.

### THE PARK

Available Acres.....	70
Total Acres.....	72
Ownership.....	Municipal
Zoning.....	Industrial/Commercial

### TRANSPORTATION

Nearest Interstate.....	I-43
Distance.....	5 Miles
Nearest Airport.....	SBM
Distance.....	2 Miles
Rail Serviced.....	WSOR
Distance.....	200'

### UTILITIES

Water.....	Municipal
Sewer.....	Municipal
Electricity.....	Sheboygan Falls Utilities
Natural Gas.....	Wisconsin Public Service
Telecom.....	AT&T

### PROVIDERS

### SHEBOYGAN COUNTY

Sheboygan County, Wisconsin is located between Green Bay and Milwaukee, with a direct connection to Chicago. This region is home to many world-renowned corporations, and if you ask them why their headquarters and facilities are located in Sheboygan County, Wisconsin they will tell you this a great place to do business and employees work ethic stands heads and shoulders above the rest.

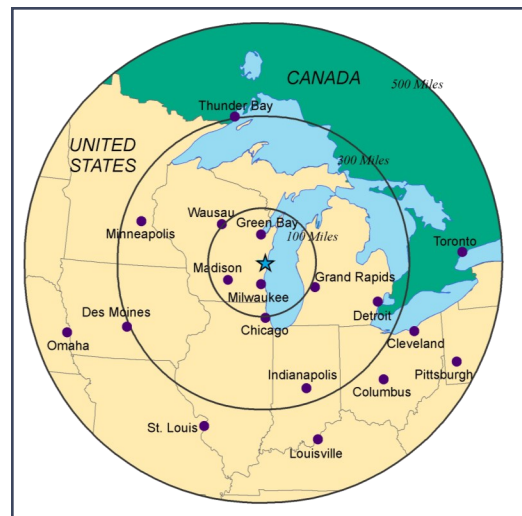
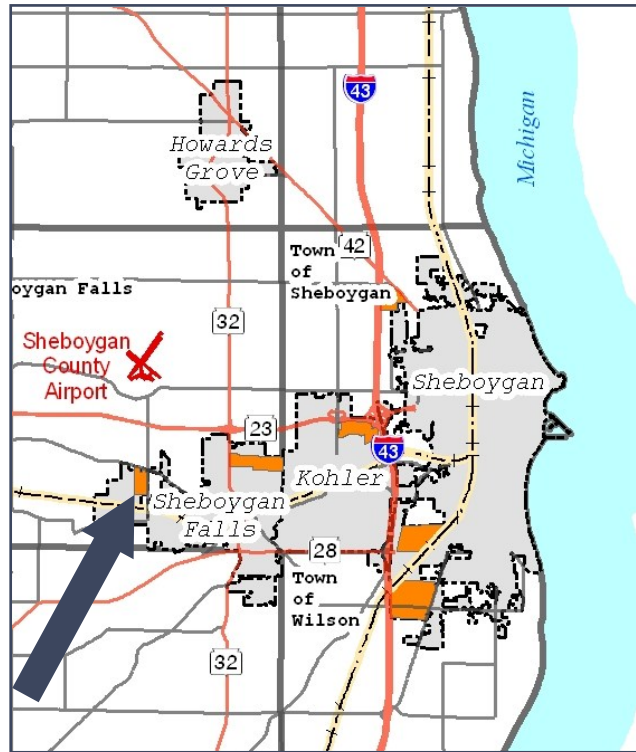

## Vision Business Park, Sheboygan Falls, WI BUSINESS PARK PROFILE

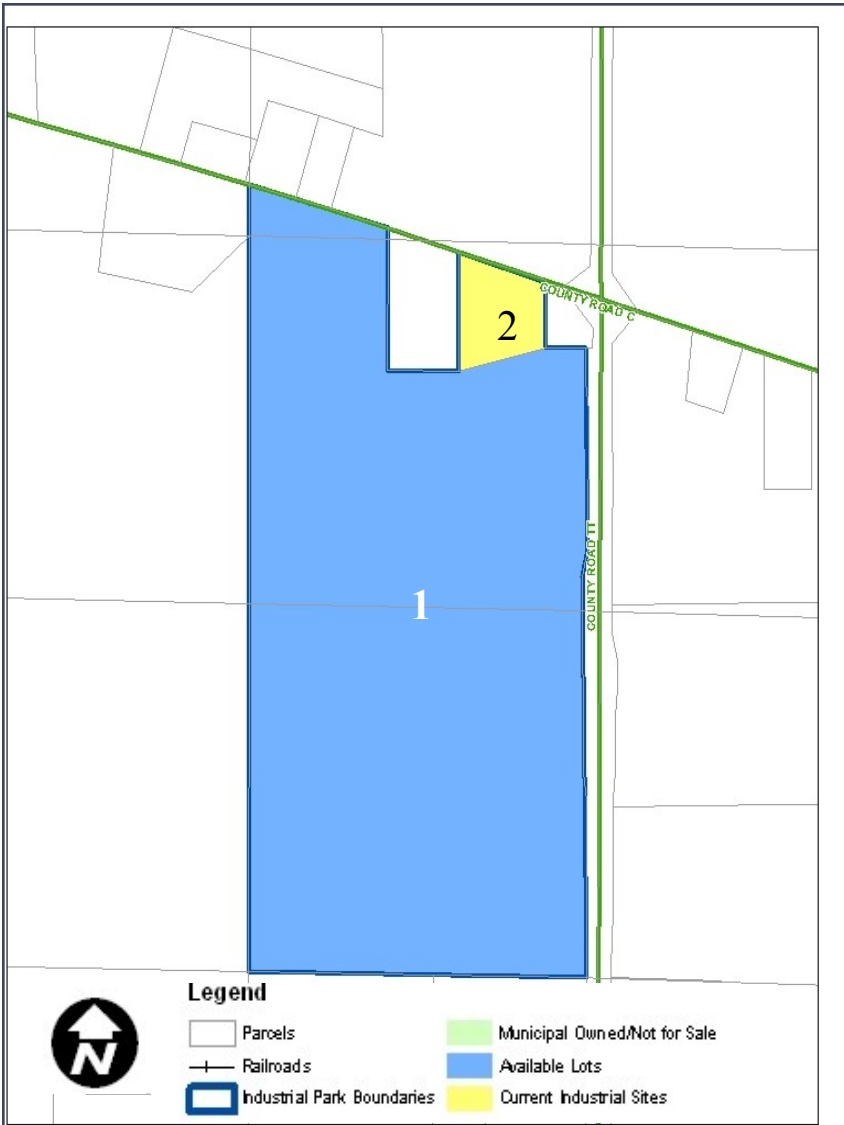

### PROPERTY OWNERS

1. Available – (70 acres, land will be divided based on the businesses needs)
2. First Internet Solutions

### NOTES

Pricing: Land can be acquired at a minimal cost in exchange for pre-determined value of improvement per acre.

Phase I of Vision Business Park consists of 72 acres, of which 70 are available for development.

### CITY OF SHEBOYGAN FALLS

The City of Sheboygan Falls has been proactive in spurring growth in the community. The City has a nationally recognized main street and is a great mix of businesses and residences. Locate in the City and you will join a terrific existing business community.

### CITY CONTACT INFORMATION

375 Buffalo Street, PO Box 186  
Sheboygan Falls, WI 53085  
(920) 467-7900  
[www.sheboyganfalls-wi.gov](http://www.sheboyganfalls-wi.gov)